

FS

EDW

TRAPEZOIDAL
METAL SHEETS

15° - 90°

BASIS OF DESIGN:
VELUX Fixed
Skylight (FS)

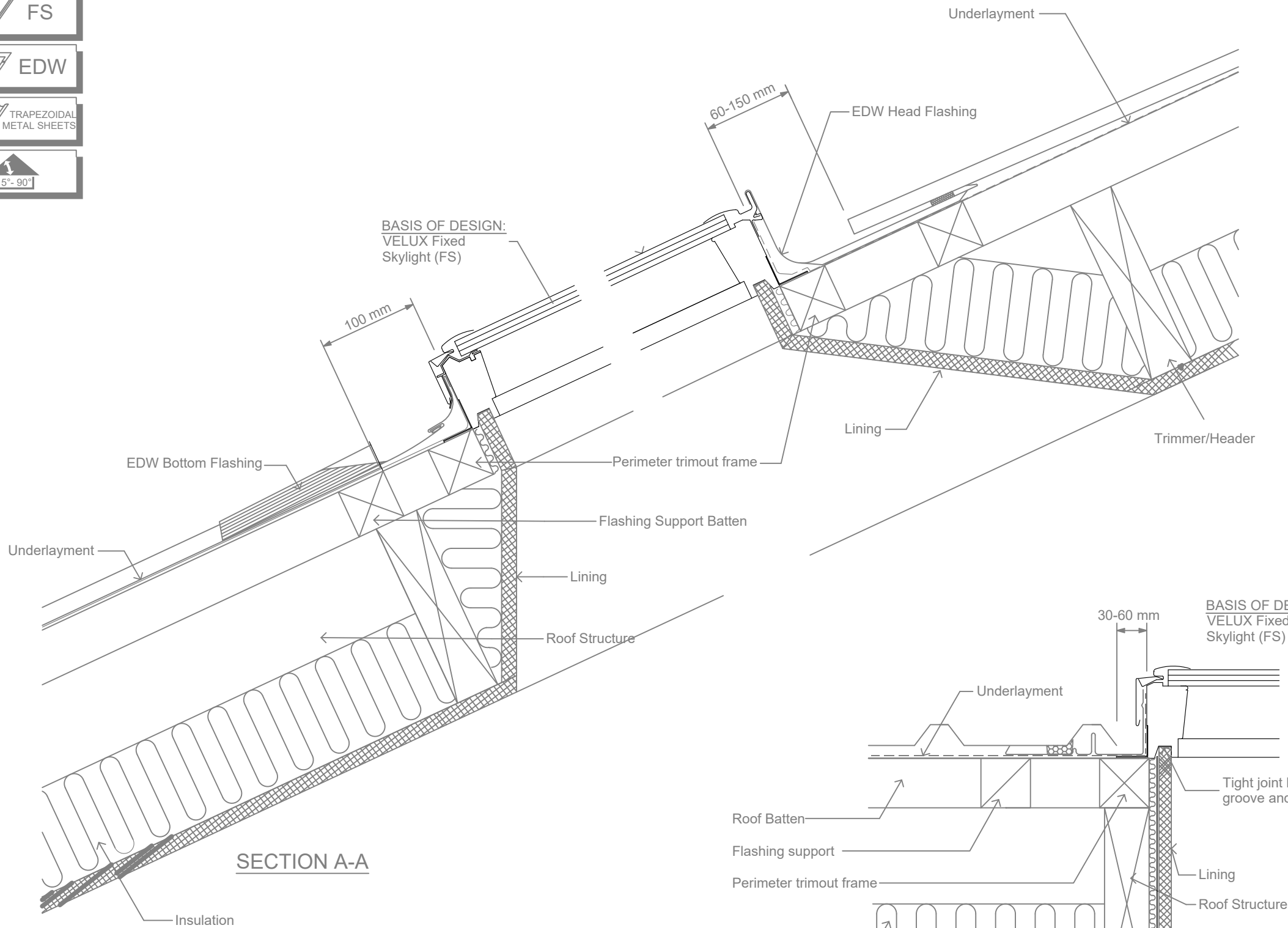

SECTION A-A

Underlayment

60-150 mm

EDW Head Flashing

Lining

Trimmer/Header

Perimeter trimout frame

Flashing Support Batten

Lining

Roof Structure

Insulation

BASIS OF DESIGN:
VELUX Fixed
Skylight (FS)

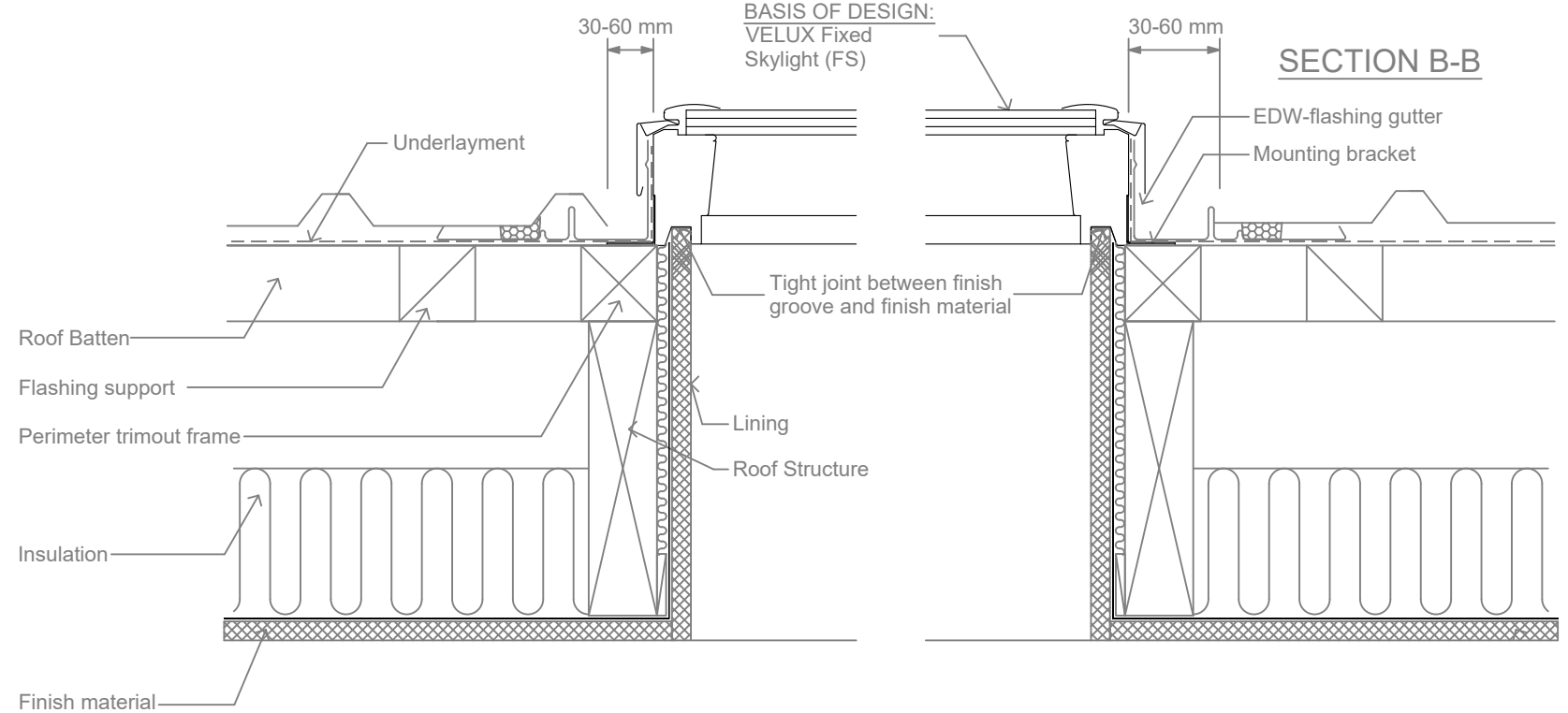

SECTION B-B

ELEVATION

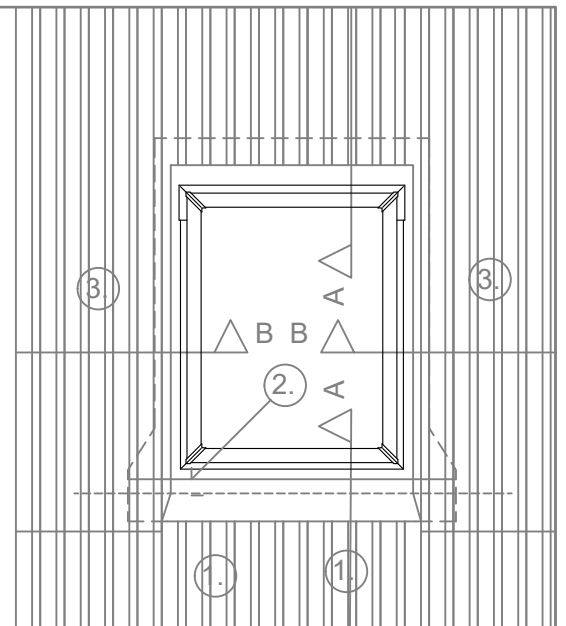

VELUX Skylight installed in new metal
roofing.

1. The sheets are fitted 100 mm from
the bottom frame
2. The flashing is mounted
3. Fit the metal sheets

FS - Fixed Skylight and EDW Flashing in Trapezoidal Metal Roof

VELUX
Sky-Product Management

NEW ZEALAND LTD.
0800 650 445

	Name	Date
Drawn by		Jan 18
Checked by		Jan 18
Drawing No.		

This drawing is an instrument of service and is provided for informational use only.

© 2011 VELUX GROUP

© VELUX is a registered trademark